



# JACKHAMMER™



JH300 – 300 WATT MONO BLOCK, CLASS-D, JACKHAMMER AMPLIFIER

JH600 – 600 WATT MONO BLOCK, CLASS-D, JACKHAMMER AMPLIFIER

## EBC MOUNTING

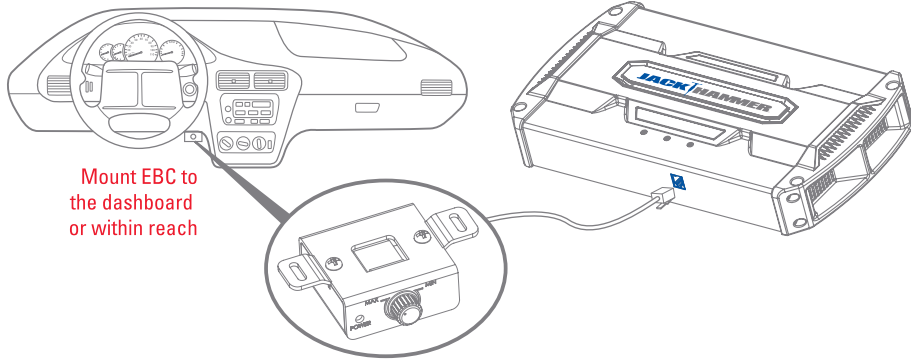

Mount EBC to the dashboard or within reach

## JACKSTAND™ INSTALLATION

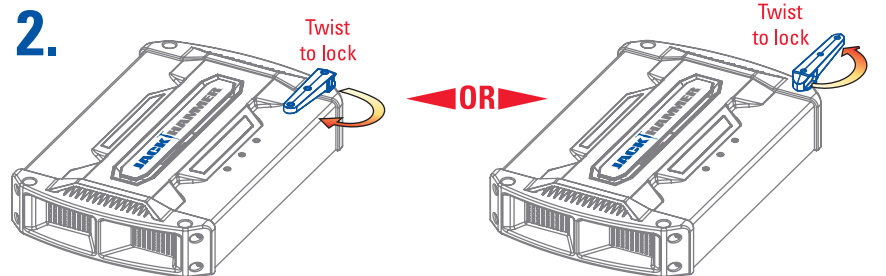
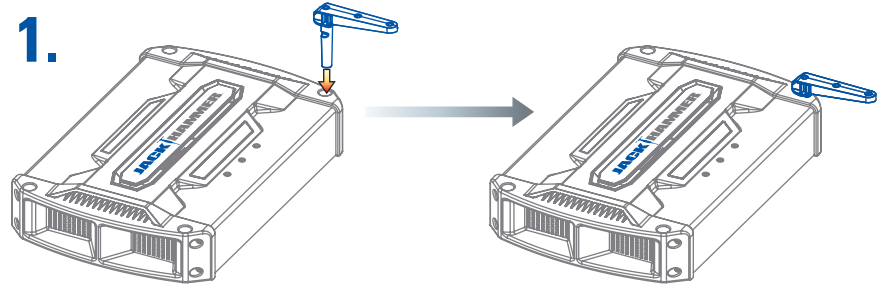

**CAUTION:** JackStands are designed for stacking a maximum of three tiers of JackHammer Amplifiers and are not intended for installation within the passenger compartment of the vehicle.

## EBC ADJUSTMENT

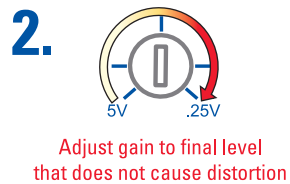
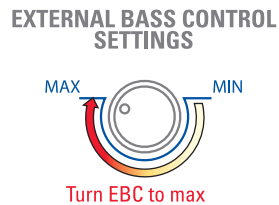
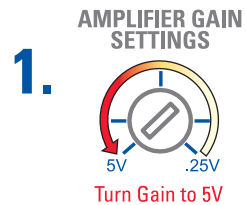

## ACTIVE FAN COOLING™ WARNING

Do not block air inlets (top) or outlets (sides) for best performance

