

EBC MOUNTING

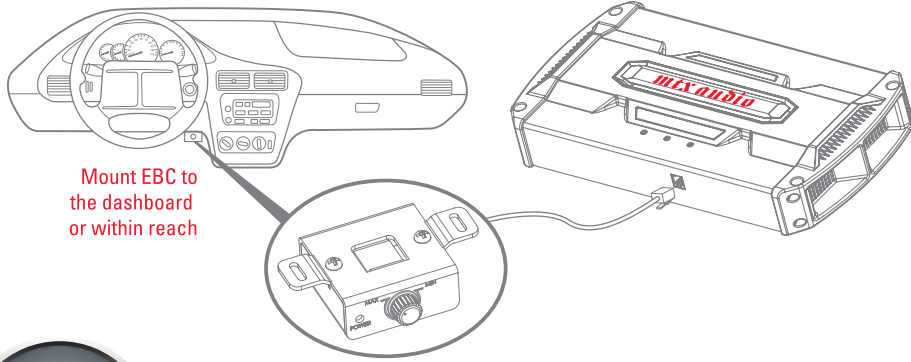

Mount EBC to the dashboard or within reach

EBC

Available separately

EBC ADJUSTMENT

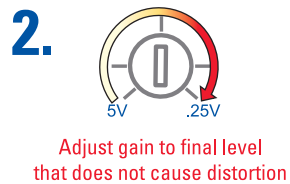
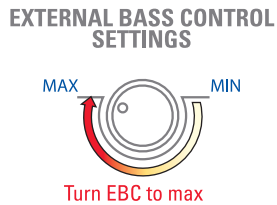
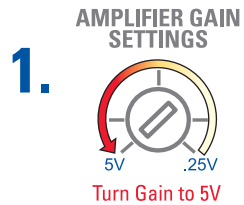

NOTE: EBC will adjust the output level of all speakers connected regardless of crossover settings.

JACKSTAND™ INSTALLATION

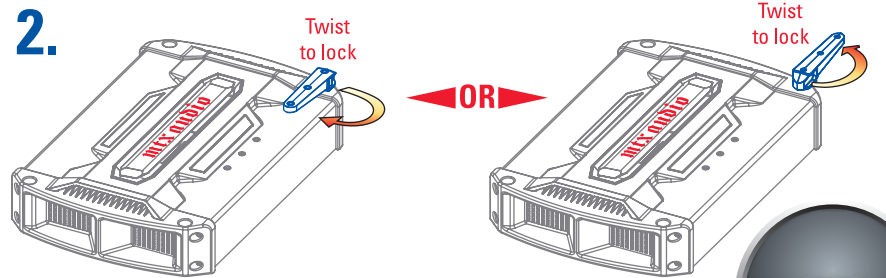
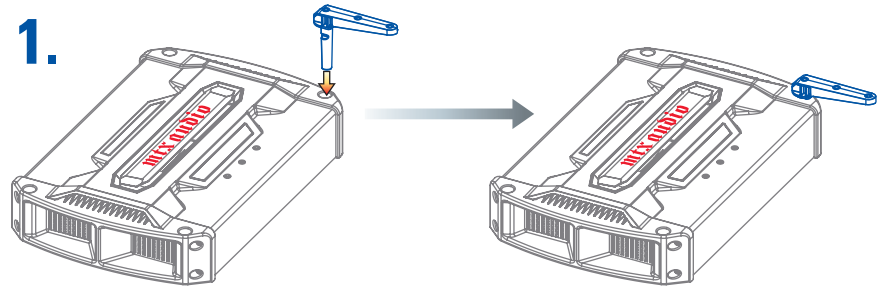

CAUTION: JackStands are designed for stacking a maximum of 3 tiers of RFL Series Amplifiers and are not intended for installation within the passenger compartment of the vehicle.

JACK STANDS

ACTIVE FAN COOLING™ WARNING

Do not block air inlets (top) or outlets (sides) for best performance

