



ALL-WEATHER BLUETOOTH CONTROLLER



AWBTC

INTRODUCTION

Congratulations on the purchase of your new MTX gear. For over 50 years MTX remains an American family-owned manufacturer full of passionate enthusiasts just like you. Thank you for counting on us to help you "Amplify The Ride"!

For best performance and longevity of your audio gear, we recommend you have your new MTX product installed by an Authorized MTX Dealer. Their installation knowledge and expertise will ensure you get the most out of your new equipment while safeguarding against potential issues. Also, please read your product warranty carefully and retain your receipt and original carton for possible future use.

We're here to help with any installation or technical support. Visit www.mtx.com to chat, call 1-800-225-5689 to speak with an MTX Technical Support representative, or visit www.youtube.com/user/MTXAudioUSA to view product videos.

Don't forget to register your new MTX product. Visit www.mtx.com/productregistration or scan the QR code below.

Model # _____
Serial # _____
Dealer's Name _____
Date of Purchase _____



TABLE OF CONTENTS

- 2. Introduction / Safety
- 3. Features / Package Contents
- 4. Control Functions
- 8. Installation
- 11.Wiring
- 15.Dimensions
- 16.Specifications
- 19.Warranty

SAFETY

- Please read and follow these instructions to prevent injury and damage to the unit.
- If you are unsure about installing the system by yourself, please have it installed by a qualified MTX technician.
- Whenever working on the vehicle, it is recommended to disconnect the battery prior to starting work. Failure to do so may lead to a risk of electric shock or equipment damage.

When connecting power and ground wires ensure that the power wire is fused at the point where it is connected to the vehicle's battery. Failure to do so can result in damage to the vehicle if a short circuit develops between the vehicle connection point and the product.

⚠ WARNING: This symbol with "WARNING" is intended to alert the user to the presence of important operating and maintenance (servicing) instructions in the literature accompanying the product.

⚠ CAUTION: This symbol with "CAUTION" is intended to alert the user to the presence of important operating and maintenance (servicing) instructions in the literature accompanying the product.

FEATURES

- Bluetooth Receiver / Controller
- IP65 Rated Weather-Proof Design
- 2 Sets of 4V RCA Preouts
- Rotary Volume Control
- Three Mounting Options: Surface, Flush, or Clamp

PACKAGE CONTENTS

- All-Weather Bluetooth Controller
- Flush Mounting Cup and Bracket
- Two (2) Flush Cup Mounting Screws
- Small Clamp Mounting Bracket
- Large Clamp Mounting Bracket
- Slotted Hex Nut
- Double-Sided Tape
- Owner's Manual

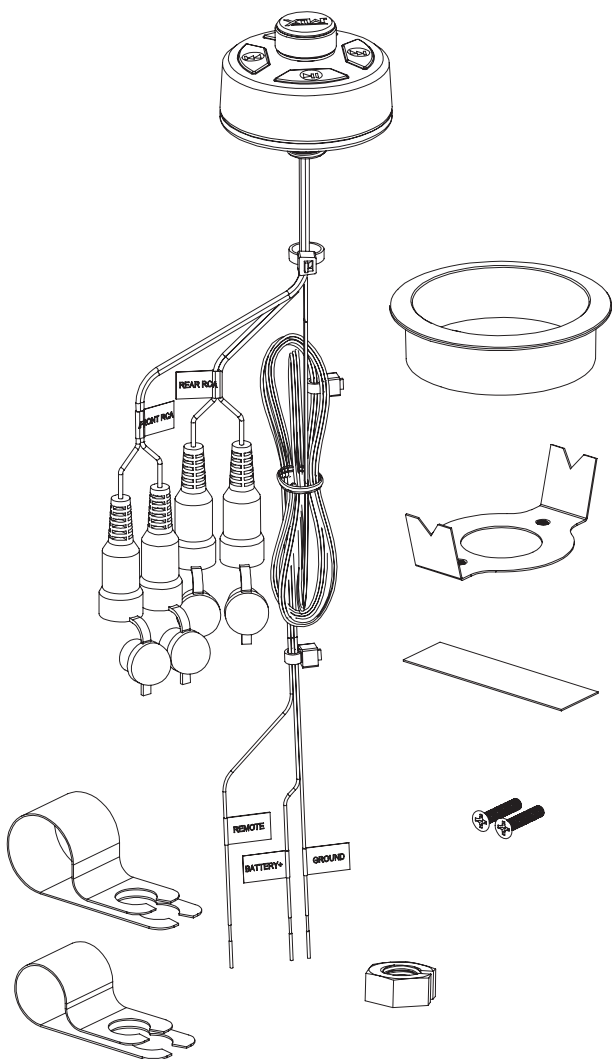

CONTROL FUNCTIONS

1. Power Button - This push button is used to turn the AWBTC on and off. When the AWBTC is powered on, the 4 buttons on the face of the unit illuminate, and it automatically begins searching for Bluetooth connections.

Note:

- a. To pair a mobile device to the AWBTC, access the Bluetooth Settings on the mobile device and select "AWBTC". When the device is successfully paired, the audio on the device will begin to play through the AWBTC.
 - b. Once a mobile device has been paired, it will automatically connect when the AWBTC is powered on until it is manually unpaired / forgotten on the mobile device.
2. Play / Pause Button - This push button is used to play and pause the audio being played on the connected Bluetooth device.

3. Previous Track Button - This push button selects the previous track to be played on the connected device.
4. Next Track Button - This push button selects the next track to be played on the connected device.
5. Volume / Bluetooth Knob - When rotated, this knob adjusts the volume of the audio being played on the connected device.

Note: The volume controls on the connected device remain active when connected, and must be turned up to achieve the full output of the AWBTC.

The Volume / Bluetooth knob is also used to connect / disconnect the paired device. Press the knob to connect to a paired device. Press and hold the knob for 2 seconds to disconnect the paired device.

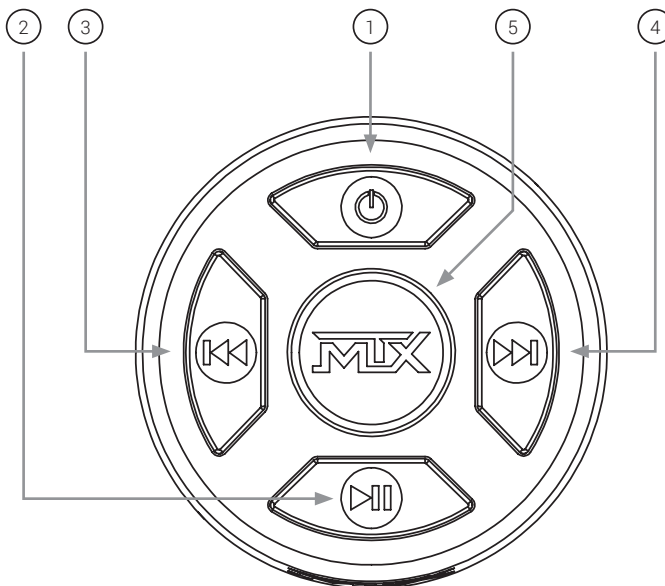

INSTALLATION

MTX recommends your new AWBTC be installed by an Authorized MTX Dealer. Any deviation from specified installation instructions can cause serious damage to the amplifier, speakers and / or vehicle's electrical system. Damage caused from improper installation is NOT covered under warranty. Please verify all connections prior to system turn on!

The AWBTC can be used with any external 12-volt amplifier and can be mounted in a variety of ways using the included hardware.

SURFACE MOUNTING

1. Locate a flat surface in the vehicle suitable for the AWBTC to be surface mounted with adequate clearance behind it for the threaded mounting post, hex nut, and all wiring.
2. When the mounting location has been determined, drill a 3/4" hole in the panel.
3. Feed the wiring harness and threaded mounting post through the hole in the panel taking care not to pinch or damage the RCA cables and connectors.
4. Slide the slotted nut over the wiring harness and thread onto the mounting post. Tighten against the back of the panel until the AWBTC is secure and does not rotate. Do not over tighten.

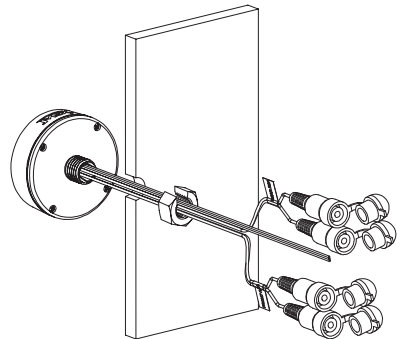
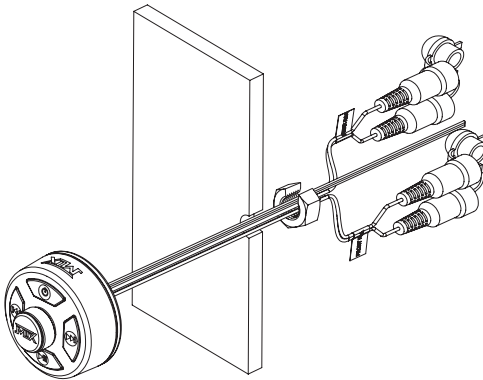

FLUSH MOUNTING

1. Locate a flat surface in the vehicle suitable for the AWBTC to be flush mounted with adequate clearance behind it for the flush mounting cup and bracket, threaded mounting post, hex nut, and all wiring.
2. When the mounting location has been determined, cut a 2.5" in diameter circular hole in the panel. Test fit the plastic mounting cup and trim the panel as needed until it sits flat.
3. When the fit is confirmed, insert the plastic flush mounting cup through the front of the panel, align the metal bracket behind the panel and secure with the included mounting screws.
4. Feed the wiring harness and threaded mounting post through the hole in the flush cup taking care not to pinch or damage the RCA cables and connectors.
5. Slide the slotted nut over the wiring harness and thread onto the mounting post. Tighten against the back of the flush cup until the AWBTC is secure and does not rotate. Do not over tighten.

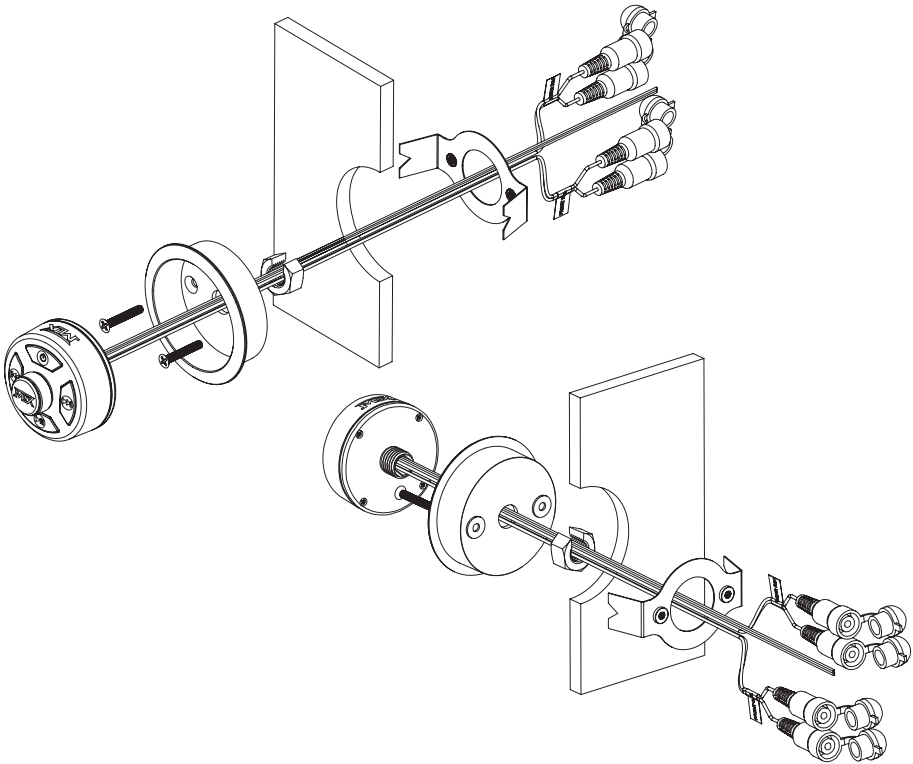

CLAMP MOUNTING

1. Locate a straight section of the bar suitable for the AWBTC to be mounted and determine which size clamp will fit correctly. Confirm there is adequate clearance behind it for the threaded mounting post, hex nut, and all wiring.
2. Slide the clamp onto the bar and align the slots for the threaded mounting post to pass through. Note that the clamps have a longer slot on one side and can be bent / shaped to allow for size adjustment.
3. Feed the wiring harness and threaded mounting post through the slots in the clamp taking care not to pinch or damage the RCA cables and connectors.
4. Slide the slotted nut over the wiring harness and thread onto the mounting post. Tighten against the back of the clamp until the AWBTC is secure and does not rotate. Do not over tighten.

Note: The included double-sided tape can be applied to the inside of the clamp to prevent it from rotating on the bar if needed.

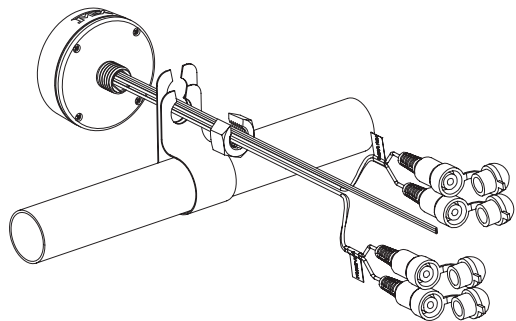
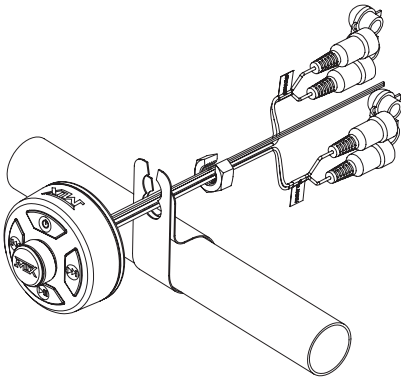

WIRING

1. **Power Wire (Red)** - Connect to fused +12V power source (5A fuse recommended)
2. **Ground Wire (Black)** - Connect to chassis ground
3. **Remote Turn-on Wire (Blue)** - Connect to amplifier remote turn-on lead / terminal

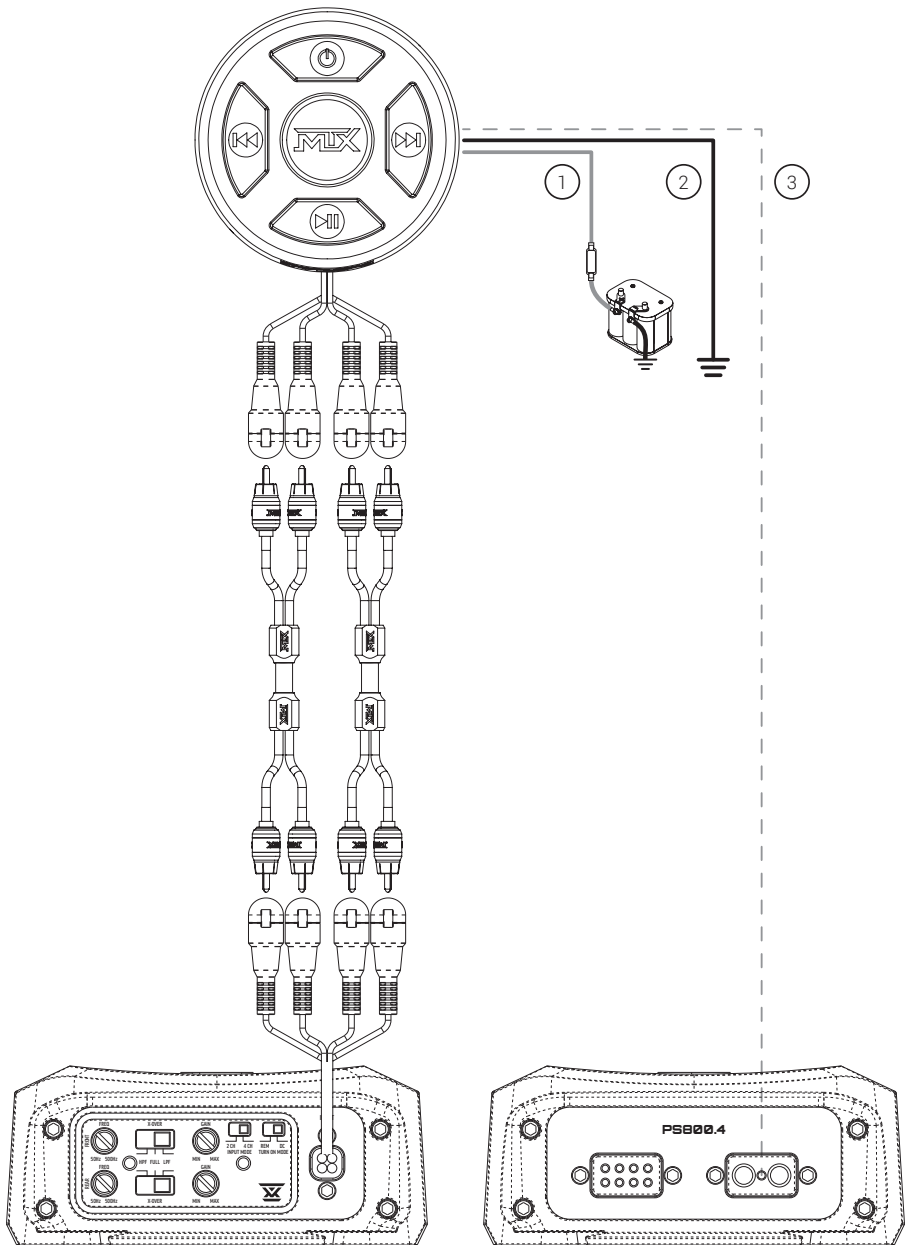

DIMENSIONS

Unit Diameter (A)	Unit Depth (B)	Cup Diameter (C)	Cup Mounting Depth (D)	Cup Cutout Diameter (E)
2 3/8" (59mm)	1 7/16" (36mm)	3" (76mm)	3/4" (19mm)	2 1/2" (64mm)

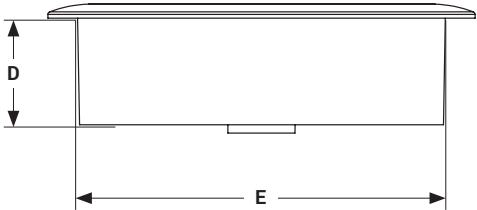
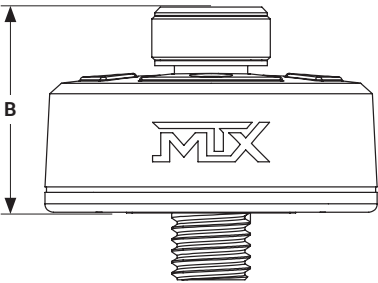
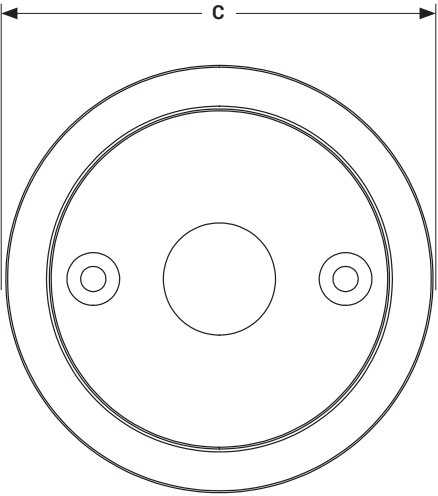
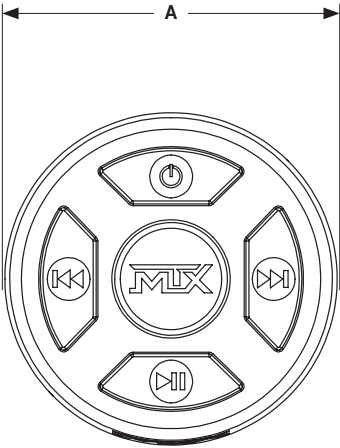

NOTES

This image shows a single sheet of white paper with horizontal ruling lines. The lines are evenly spaced and run across the width of the page. There are no margins, text, or other markings on the paper.

MITEK WARRANTY

MiTek Mobile products (including, but not limited to: MTX, Coustic, Streetwires, Xtant, BassSlammer, and Thunder Marine) purchased in the USA from an AUTHORIZED MITEK DEALER are guaranteed against defects in material and workmanship for two years. The warranty period begins the day the product is purchased by the end user, and this warranty is limited to the original retail purchaser of product. Products found to be defective during the warranty period will be repaired or replaced with equivalent product by MiTek at no charge. This warranty is void if it is determined that unauthorized parties have attempted repairs or alterations of any nature, and the warranty does not extend to cosmetics or finish. MiTek disclaims any liability for other incurred or consequential damages resulting from product defects. MiTek's total liability will not exceed the purchase price of the product.

We're here to help! If you experience an issue with any of our products, please contact our customer service technical line at 1-800-CALL-MTX to help troubleshoot your issue. If after speaking with our technical experts it is determined that your product is defective, the technician will provide you with a Return Authorization number and all relevant details you'll need to process your claim quickly.

Let's Get Social **mtx.com**



Like, Follow, & Subscribe

© 2025 MiTek Corporation. All rights reserved. MTX is a trademark of MiTek Corporation. All other trademarks are property of their respective owners. Designed and Engineered in the U.S.A.

Due to continual product development, all specifications are subject to change without notice.

MTX Audio, 4545 East Baseline Rd. Phoenix, AZ 85042 U.S.A. 1-800-225-5689

MTX008208 RevA 6/25 • AW0016468 • 1-23123

MTX.COM