

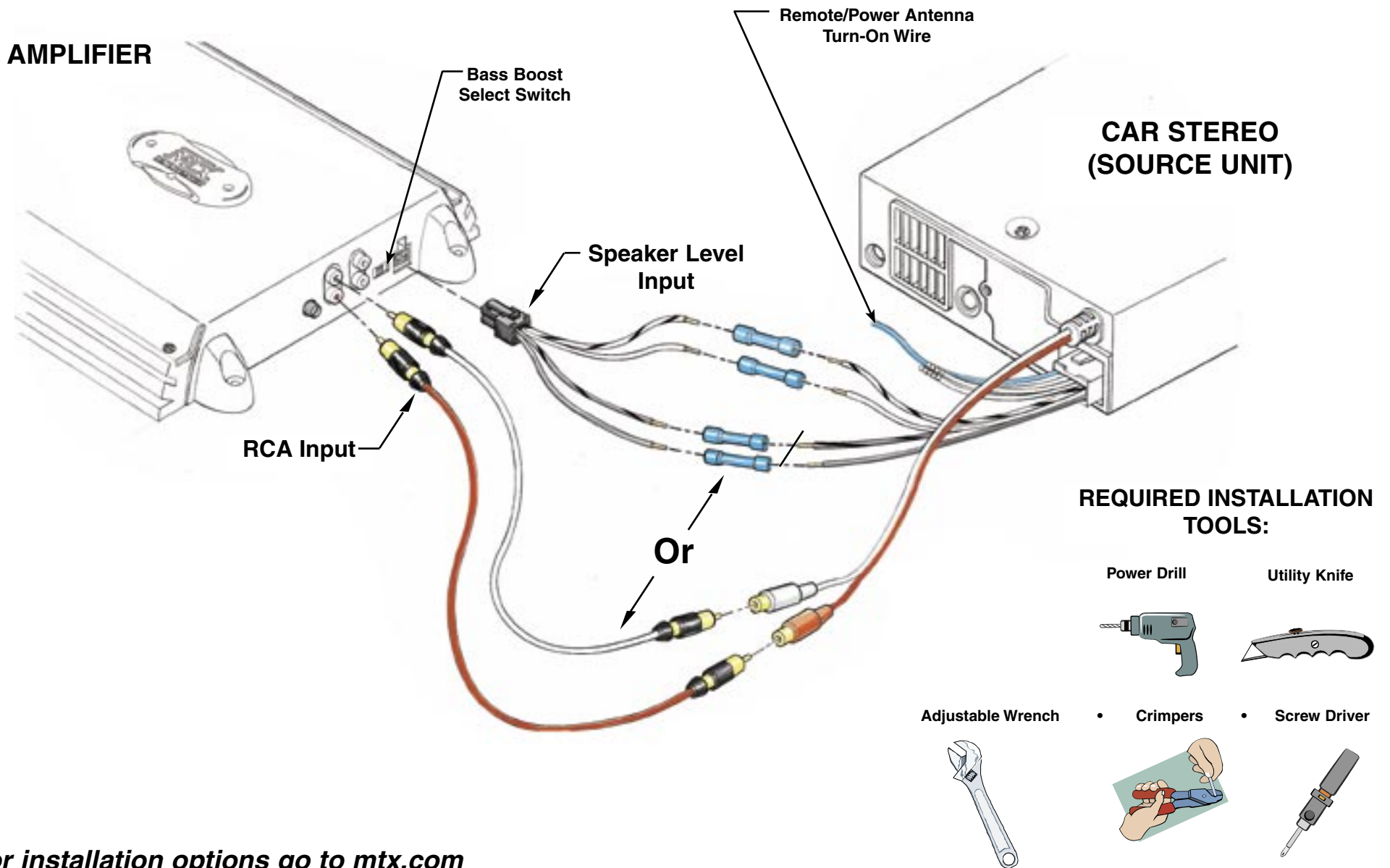

# THUNDER 251D / THUNDER 311D

## Amplifier Input Connections



For installation options go to [mtx.com](http://mtx.com)

Part #: NDM225



# THUNDER 251D / THUNDER 311D

## Amplifier Output Connections

AMPLIFIER

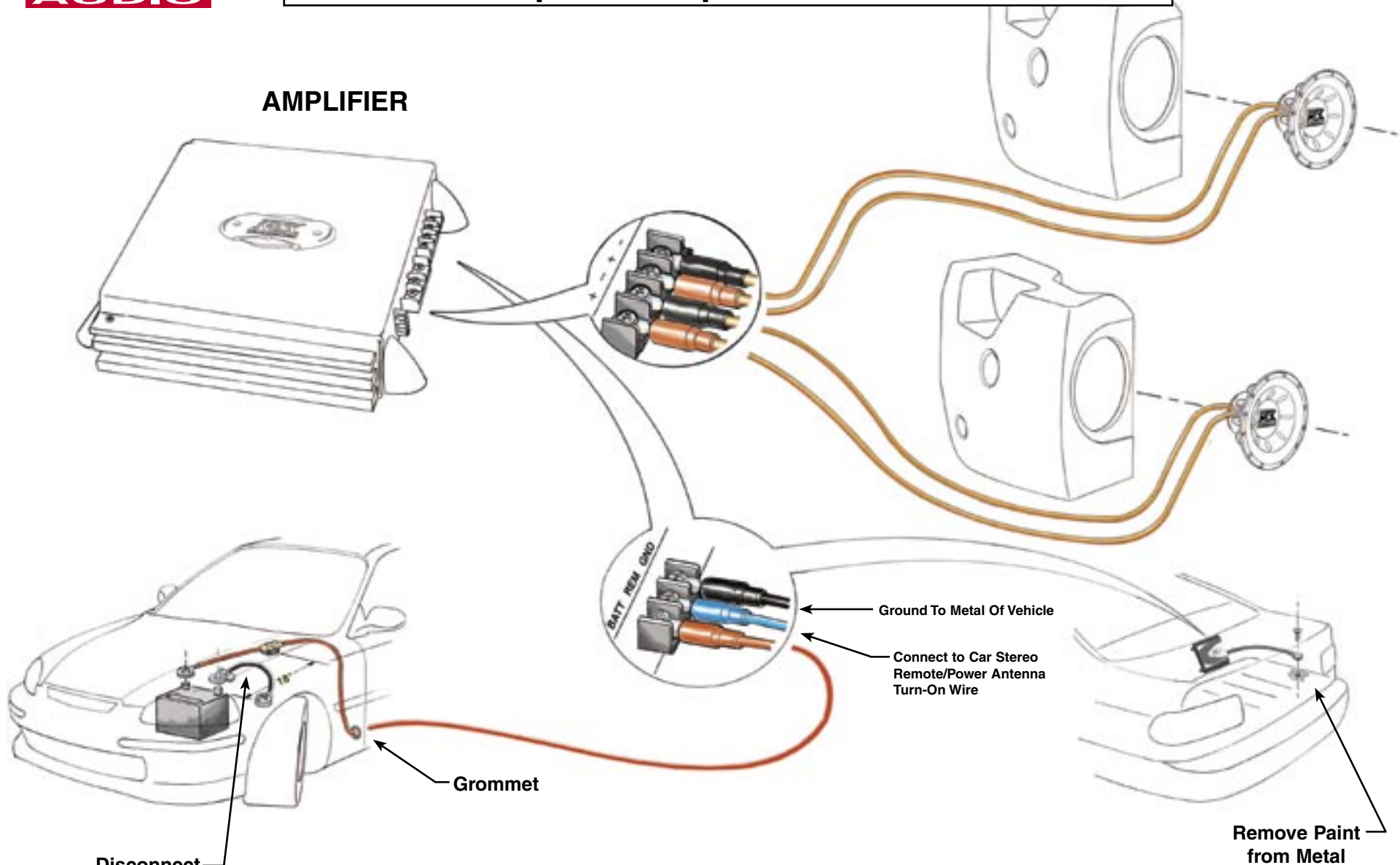

Disconnect  
Battery Negative (-) Cable  
Prior to Installing Amplifier

Grommet

Ground To Metal Of Vehicle

Connect to Car Stereo  
Remote/Power Antenna  
Turn-On Wire

Remove Paint  
from Metal

**Minimum Wire Size:**  
Power: 10 AWG. Ground: 10 AWG.

For installation options go to [mtx.com](http://mtx.com)